

NOTE:  
THE CENTER SECTION OF THE DOCK IS DESIGNATION PHASE I  
IN THE CONSTRUCTION SEQUENCING. REFER TO THE  
SPECIFICATIONS FOR DETAILS.

**GENERAL PLAN**  
1" = 30'

**GENERAL NOTES:**

- CONCRETE PILES:**  
SEE DRAWINGS NO. 807-A-7, 8, 9, & 10.
- CAST-IN-PLACE CONCRETE**  
CONCRETE SHALL HAVE A MINIMUM COMPRESSIVE STRENGTH OF 4000 PSI IN 28 DAYS.
- REINFORCING STEEL:**  
REINFORCING STEEL SHALL CONFORM TO ASTM A615 GRADE 60 AND SHALL BE DETAILED IN ACCORDANCE WITH ACI STANDARD 318 AND THE CRSI MANUAL OF STANDARD PRACTICE. A MINIMUM OF 2" CONCRETE COVER SHALL BE PROVIDED AT ALL REINFORCING BARS EXCEPT THAT 1 1/2" OF COVER SHALL BE PROVIDED AT CRANE RAIL POCKETS AND OVER CONCRETE PILES.
- CONSTRUCTION JOINTS:**  
CONSTRUCTION JOINTS SHALL BE AT MAXIMUM SPACING OF 70 FT. AND SHALL BE LOCATED AS APPROVED BY THE ENGINEER. REINFORCING BAR SPLICES SHALL NOT CROSS CONSTRUCTION JOINTS.
- PILE ALIGNMENT:**  
IN ADDITION TO DRIVING TEMPLATES, IT IS THE CONTRACTOR'S COMPLETE RESPONSIBILITY TO MAINTAIN THE PROPER ALIGNMENT OF BOTH CONCRETE PILES AND STEEL SHEET PILES UNTIL ENCASED IN CONCRETE.

**DESIGN LOADS:**

**BUCKET UNLOADER WHEEL LOADS**

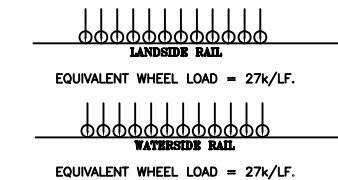

**UNIFORM LOADS:** 750 PSF

REV.	DATE	DESCRIPTION
B	8/10/95	REVISED ANCHOR BOLT LOCATIONS
A	7/12/95	ISSUED FOR BIDS
<b>ALABAMA STATE DOCKS DEPARTMENT</b>		
<b>MOBILE ALABAMA</b>		<b>McDUFFIE TERMINALS DOCK No. 3</b>
<b>Gottlieb Barnett Bridges</b>		<b>GENERAL PLAN</b>
Drawn By:	E.L.R.	Date: JUNE 95
Checked By:	R.S.G.	Date: JULY 95
Scale:	NOTED	DRAWING NO. <b>807-A-1</b>

CAD Name: 807-A-1  
Plot Date: 8/10/95 1:35



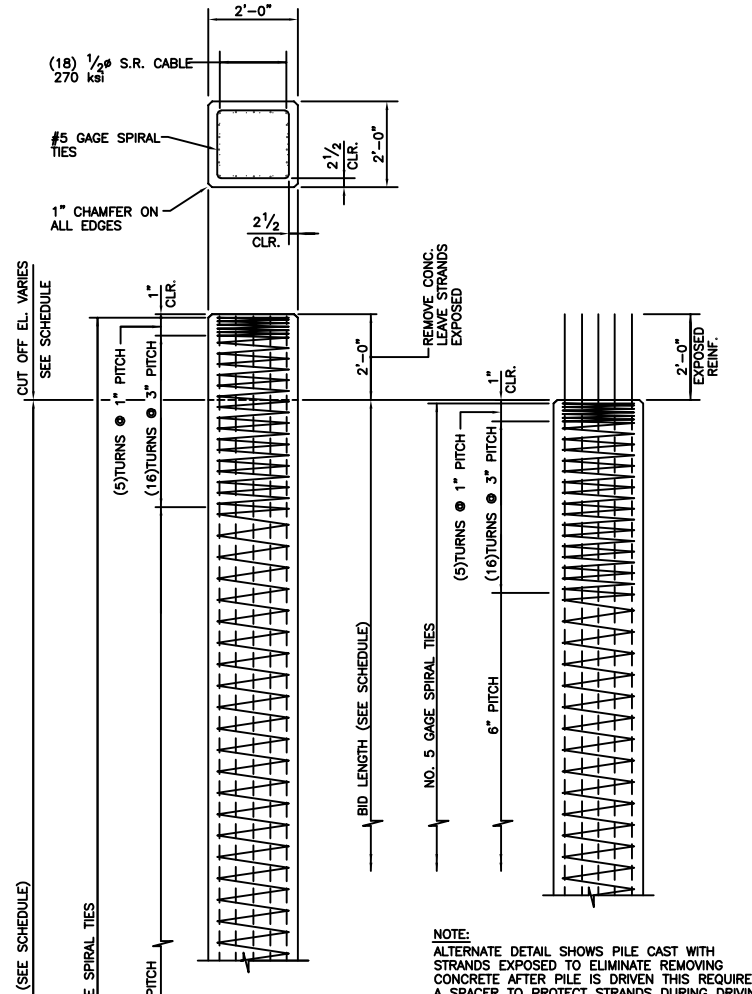

NOTE:  
ALTERNATE DETAIL SHOWS PILE CAST WITH STRANDS EXPOSED TO ELIMINATE REMOVING CONCRETE AFTER PILE IS DRIVEN THIS REQUIRES A SPACER TO PROTECT STRANDS DURING DRIVING.

**ALTERNATE END DETAIL**  
1/2"=1'-0"

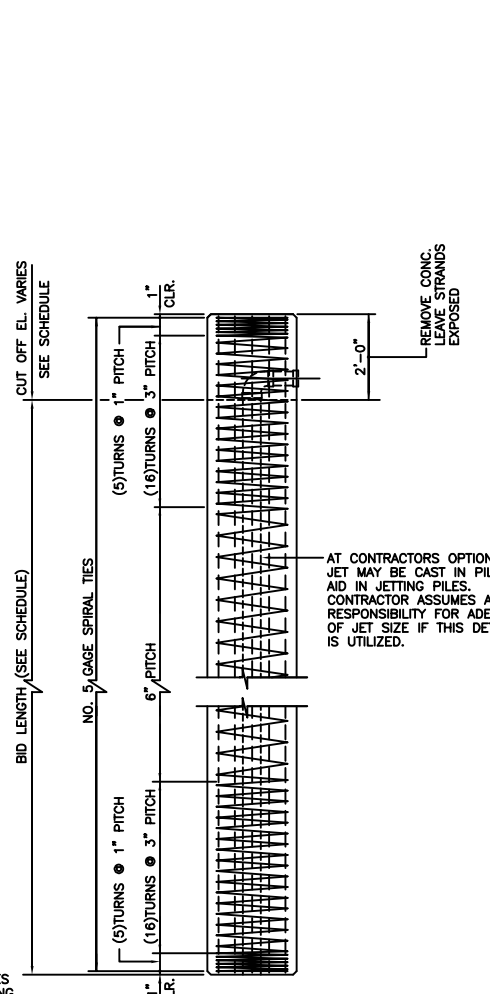

AT CONTRACTORS OPTION 4" PVC JET MAY BE CAST IN PILES TO AID IN JETTING PILES. CONTRACTOR ASSUMES ALL RESPONSIBILITY FOR ADEQUACY OF JET SIZE IF THIS DETAIL IS UTILIZED.

**ALTERNATE CAST IN JET**  
1/2"=1'-0"

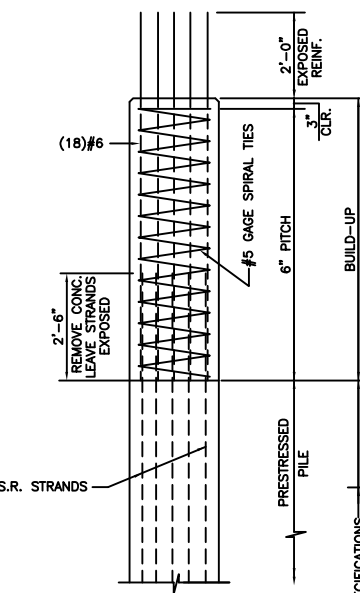

**WITHOUT DRIVING**

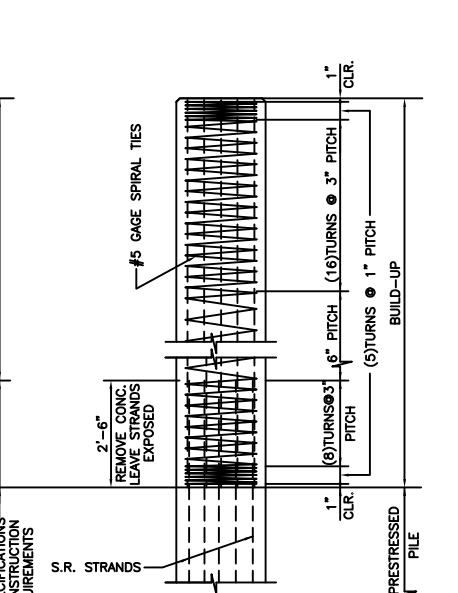

**WITH DRIVING**

SEE SPECIFICATIONS FOR CONSTRUCTION J.T. REQUIREMENTS

**24" PRESTRESSED PILE BUILD-UP DETAIL**

**24" PRESTRESSED PILE DETAIL**  
1/2"=1'-0"

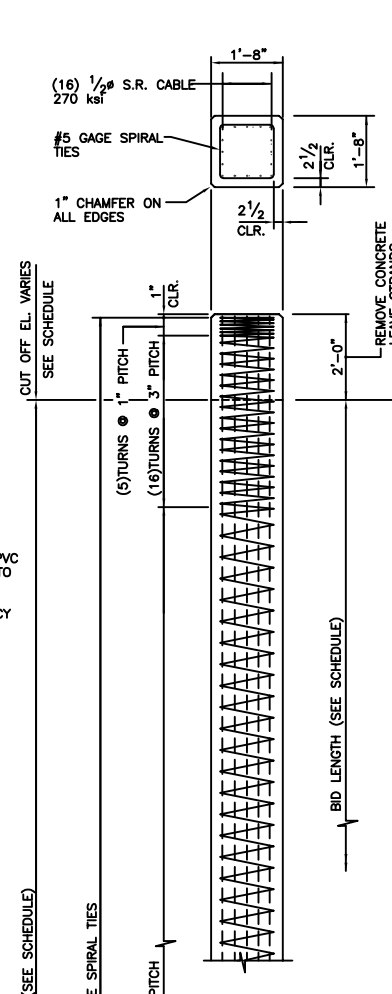

NOTE:  
ALTERNATE DETAIL SHOWS PILE CAST WITH STRANDS EXPOSED TO ELIMINATE REMOVING CONCRETE AFTER PILE IS DRIVEN THIS REQUIRES A SPACER TO PROTECT STRANDS DURING DRIVING.

**ALTERNATE END DETAIL**  
1/2"=1'-0"

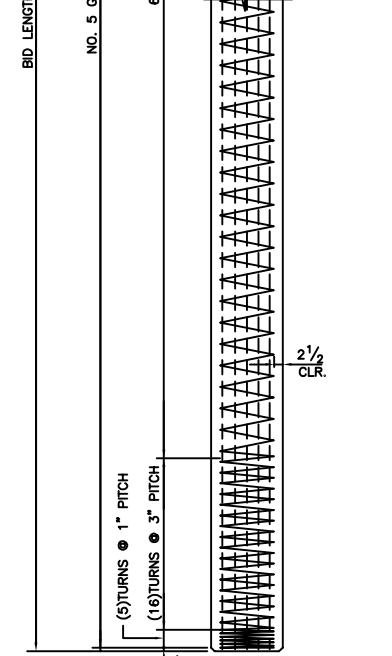

**WITHOUT DRIVING**

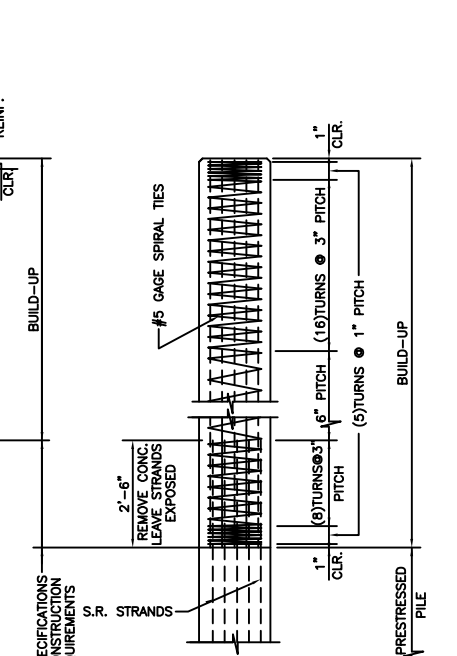

**WITH DRIVING**

SEE SPECIFICATIONS FOR CONSTRUCTION J.T. REQUIREMENTS

**20" PRESTRESSED PILE BUILD-UP DETAIL**

**20" PRESTRESSED PILE DETAIL**  
1/2"=1'-0"

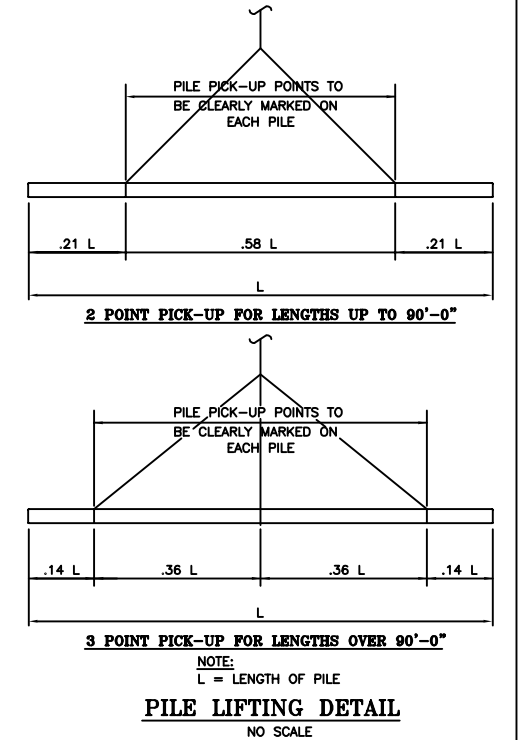

**CONCRETE PILE NOTES:**

1. PRESTRESSED PILES & PILE BUILD-UPS SHALL CONFORM TO THE REQUIREMENTS OF THE JOINT COMMITTEE OF AASHTO AND PCI FOR PRESTRESSED CONCRETE PILES UNLESS OTHERWISE NOTED OR SPECIFIED.
2. CONCRETE FOR PRESTRESSED PILES & PILE BUILD-UPS SHALL HAVE A MINIMUM COMPRESSIVE STRENGTH OF 5000 PSI IN 28 DAYS.
3. PRESTRESSING REINFORCEMENT SHALL CONFORM TO ASTM A416.
4. REINFORCING FOR PILE BUILD-UPS SHALL CONFORM TO ASTM A615 GRADE 60.
5. ALL PILE RECORDS SHALL USE NUMBERING SYSTEM SHOWN ON DWG. 807-A-7.
6. ROW (G) AND (10) VERTICAL PILES AND ROW (20) BATTER PILES SHALL BE DRIVEN IN ADVANCE OF STEEL SHEET PILES SO THAT NO ROW (G) (10) (20) PILES ARE DRIVEN WITHIN 15' OF STEEL SHEET PILING IN PLACE.
7. IN ADDITION TO DRIVING TEMPLATES, IT IS THE CONTRACTORS COMPLETE RESPONSIBILITY TO MAINTAIN THE PROPER ALIGNMENT OF THE CONCRETE PILES UNTIL ENCASED IN CONCRETE.

REV.	DATE	DESCRIPTION
A	7/12/95	ISSUED FOR BIDS
ALABAMA STATE DOCKS DEPARTMENT		
MOBILE ALABAMA		McDUFFIE TERMINALS DOCK No.3
Gottlieb Barnett Bridges		
Drawn By:	L.W.R.	Date: JUNE 95
Checked By:	R.S.G.	Date: JULY 95
Scale:	NOTED	DRAWING NO. 807-A-10

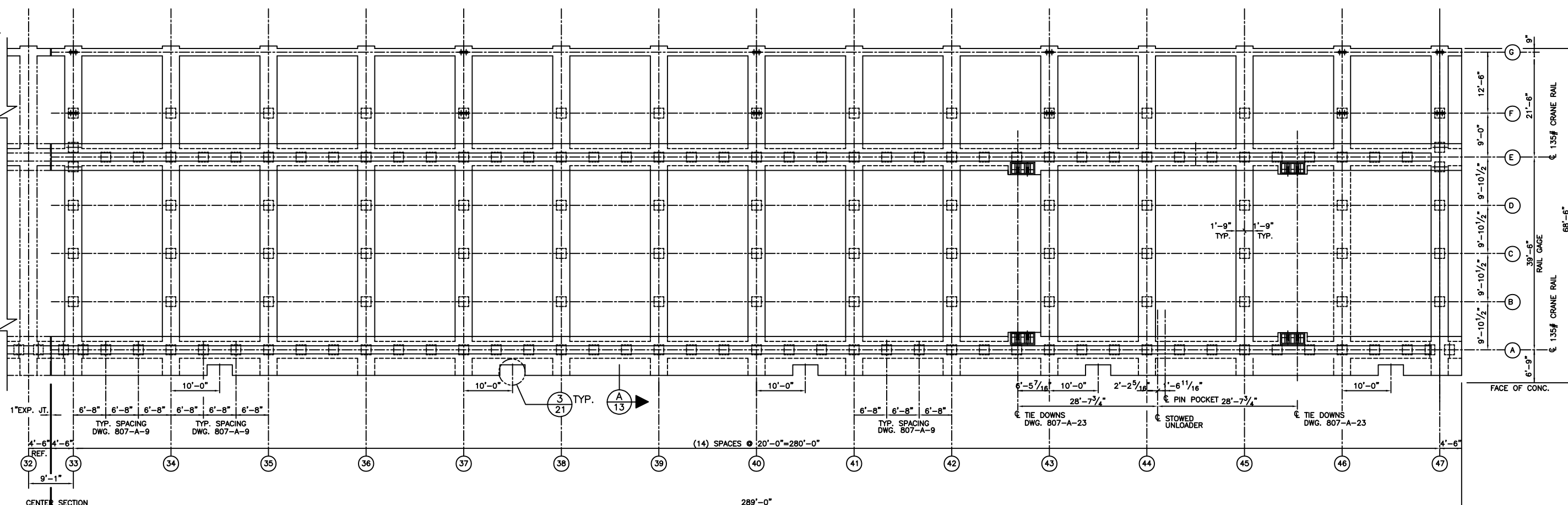
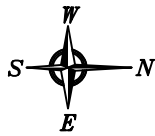

**BEAM PLAN (NORTH END)**  
1"=10'

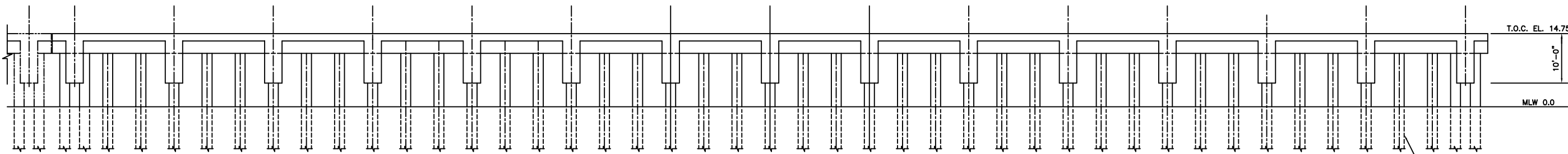

**ELEVATION (NORTH END)**  
1"=10'

PRESTRESSED CONCRETE PILES  
DWG. 807-A-10

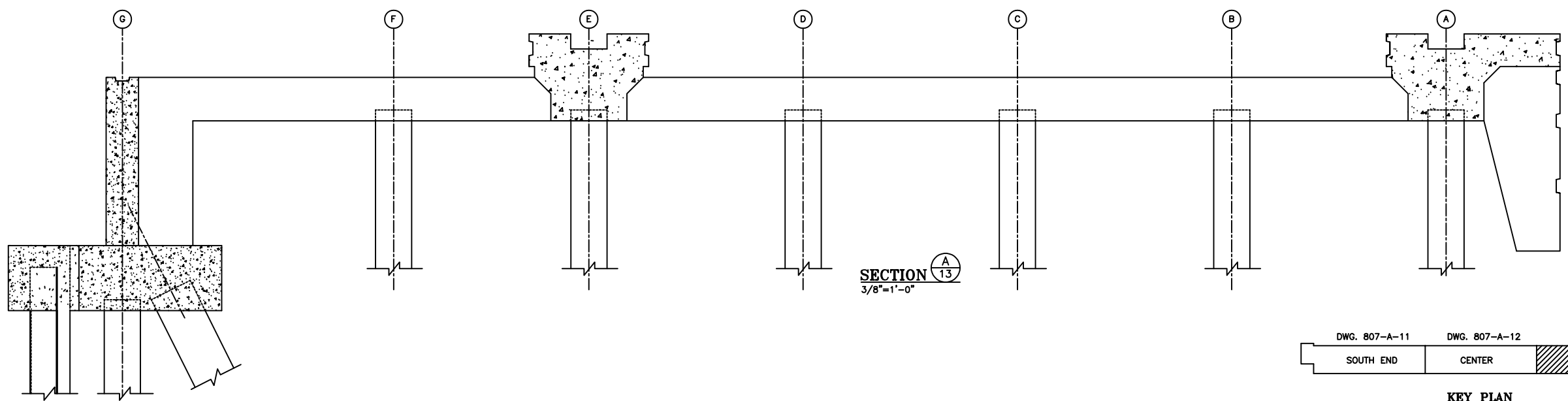

**SECTION A-13**  
3/8"=1'-0"

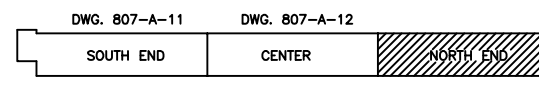

**KEY PLAN**

REV.	DATE	DESCRIPTION
A	7/12/95	ISSUED FOR BIDS
ALABAMA STATE DOCKS DEPARTMENT		
MOBILE ALABAMA		McDUFFIE TERMINALS DOCK NO. 3
Gottlieb Barnett Bridges		
Drawn By:	E.L.R.	Date: JUNE 95
Checked By:	R.S.G.	Date: JULY 95
Scale:	1"=10'	DRAWING NO. 807-A-13

CAD Drawn: 807-A-13  
 Plot Date: 7/6/95 10:20

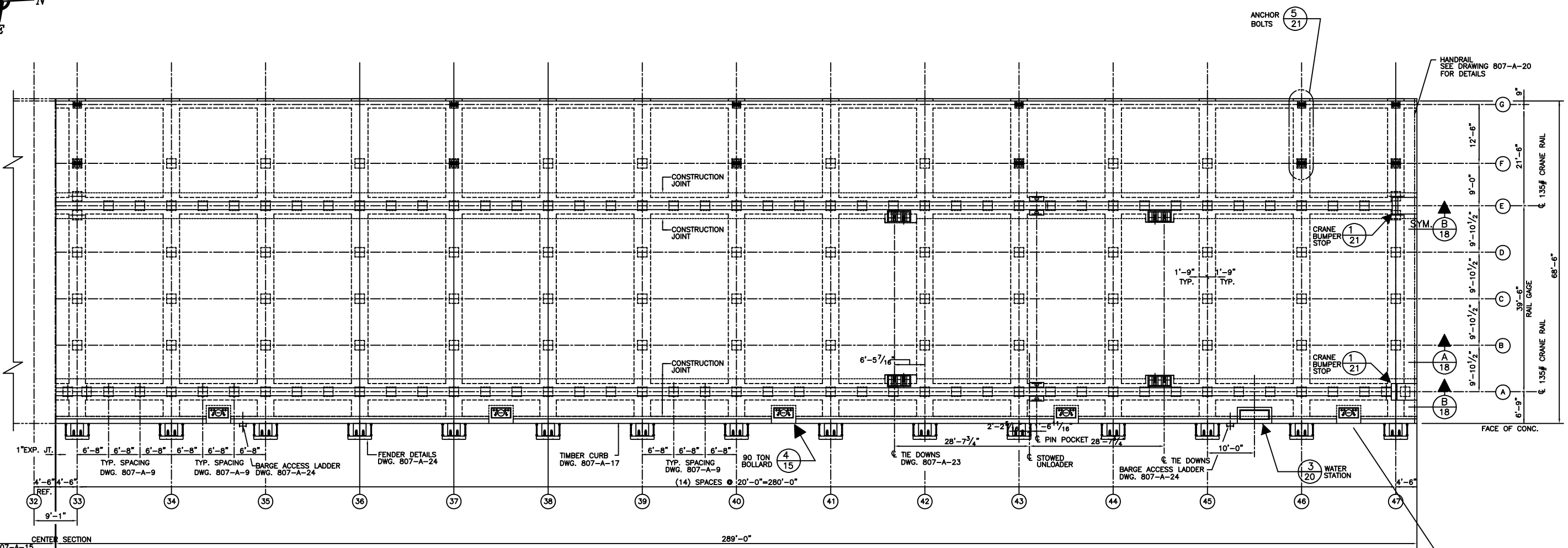
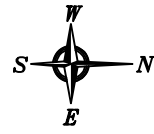

**DECK PLAN (NORTH END)**  
1"=10'

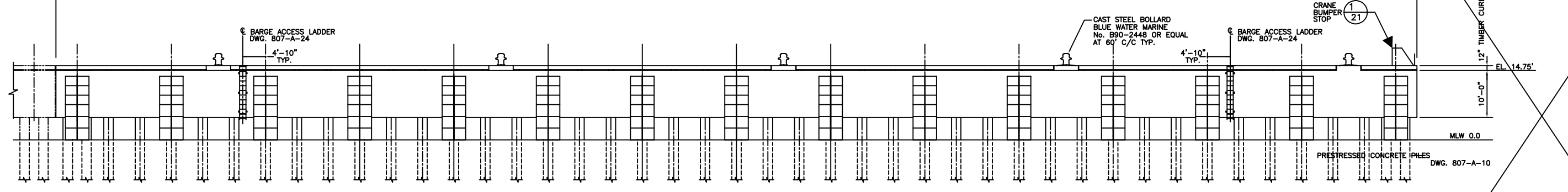

**ELEVATION (NORTH END)**  
1"=10'

NOTE:  
FOR TIMBER CURB INSERT SPACING  
SEE PLAN ON DRAWING 807-A-14. (TYPICAL)

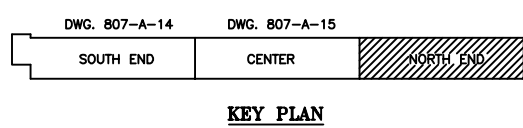

**KEY PLAN**

0	9/1/95	ISSUED FOR CONSTRUCTION
REV.	DATE	DESCRIPTION
ALABAMA STATE DOCKS DEPARTMENT		
MOBILE ALABAMA		McDUFFIE TERMINALS DOCK NO. 3
Drawn By: F.D.	Date: JUNE 95	<b>DECK PLAN AND ELEVATION</b>
Checked By: R.S.G.	Date: JULY 95	
Scale: 1"=10'	DRAWING NO. 807-A-16	0 REV.

CAD: BARNETT 8/30/95 09:30  
 DWG. 807-A-16

